

GODAI

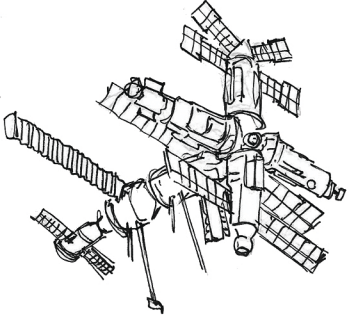

THE BRIEF HISTORY OF MANNED SPACE STATIONS

SOYUZ 4/5 (1969)

NOT REALLY A SPACE STATION, "JUST" TWO MANNED SPACECRAFTS DOCKED TOGETHER AND CREW TRANSFER IN ORBIT. THE DOORSTEP FROM WHICH HUMANKIND MADE THE LAST STE INTO SPACE.

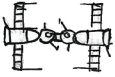

SALYUT 1 (1971)

FIRST EVER MANNED ORBITAL BASE IN HISTORY, LAUNCHED BY THE SOVIET UNION. MADE OF PART OF UNFINISHED ALMAZ SPACE STATION AND THE SOYUZ SPACECRAFT.

ONE SUCCESSFUL MISSION MANAGED TO DOCK THE STATION AND STAYED ONBOARD FOR THREE WEEKS, CONDUCTING VARIOUS SCIENTIFIC EXPERIMENTS. TRAGICALLY, ALL MEMBER OF THE 3-PERSON CREW OF SOYUZ 11 DIED ON REENTRY DUE TO PRESSURE VALVE MALFUNCTION.



SALYUT 3 (1974-1975)

ACTUALLY A MILITARY SPACE STATION **ALMAZ 2**. THE FIRST AND ONLY ARMED MANNED SPACE STATION IN HISTORY HOSTED A SINGLE 2-PERSON MISSION. EQUIPPED WITH A 30MM NUDELMANN GUN.

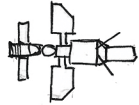

SALYUT 4 (1974-1977)

NEW, MODERNIZED SALYUT WITH BETTER ONBOARD HARDWARE AND LAB EQUIPMENT. FIRST SPACE STATION TO HOST MORE THAN ONE CREW. ALSO SERVED AS A TESTBED FOR AUTOMATED, UNMANNED FLIGHTS.

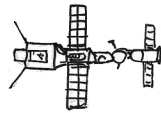

SALYUT 5 (1976-1977)

ACTUALLY A MILITARY SPACE STATION **ALMAZ 3**. HOSTED THREE 2-PERSON CREWS.

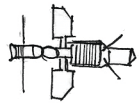

GNAZDOSWIATOW.NET



GET MORE FREE ZINES!

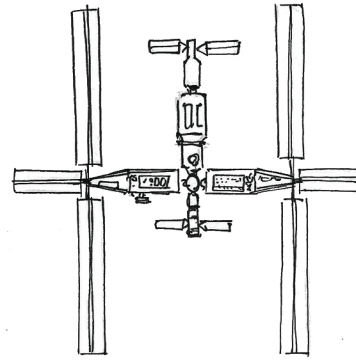

CHINESE MANNED SPACE STATION **TIANGONG 1** (SINCE 2011)
LARGE, MULTIMODULAR CONSTRUCTION COMPARABLE WITH MIR.
SUPPORTS 6 PERSON CREW, HOSTS CREW AND CARGO VESSELS.



CHINESE TEST SPACE LABORATORY, BOTH WERE SMALL, 3-PERSON SPACE LABS.
USED FOR TESTS. THE BODY WAS LATER USED IN **TIANZHOU** CARGO SHIP.
TIANGONG 2 (2016-2019) **TIANGONG 1** (2011-2018)

SALYUT 6 (1977-1982)

NEW MODEL SOVIET SPACE STATION WITH DUAL DOCKING PORTS, THAT MADE HOSTING LONG TERM CREW OF 3 POSSIBLE. ACCEPTED AUTOMATED CARGO SHIPS AND WAS VISITED BY MANY INTERNATIONAL COSMONAUTS IN THE INTERKOSMOS PROGRAMME.

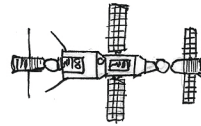

SALYUT 7 (1982-1991)

MODERNIZED VERSION THAT SERVED AS A TEST BED FOR MULTIMODULAR SPACE STATIONS. TKS SPACESHIPS WERE TESTED HERE THAT LATER MADE BASE FOR MIR STATION MODULES. SUPPORTED CREW OF 3 FOR LONG TERM MISSIONS AND MANY VISITING CREW WITH INTERNATIONAL PERSONNEL.

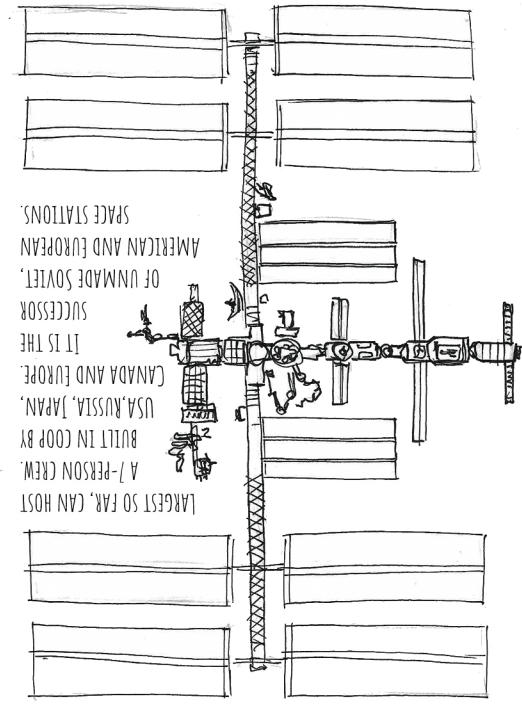
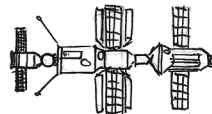

LARGEST SO FAR, CAN HOST A 7-PERSON CREW.
BUILT IN COOP BY USA, RUSSIA, JAPAN, CANADA AND EUROPE.
IT IS THE SUCCESSOR OF UNMADE SOVIET, AMERICAN AND EUROPEAN SPACE STATIONS.

INTERNATIONAL SPACE STATION (SINCE 1998)

SKYLAB (1973-1979)

FIRST AMERICAN SPACE STATION MADE OF REPURPOSED SATURN V FUEL TANK. IT HOSTED CREW OF 3 AND ACCEPTED APOLLO CRAFT, SAME THAT LANDED ON THE MOON.

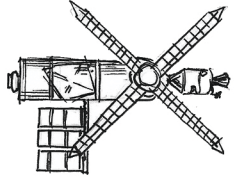

MIR (1986-2001)

FIRST TRUE MULTIMODULAR SPACE STATION BUILT BY THE SOVIET UNION/RUSSIA AND PARTIALLY FINANCED BY USA. IT SUPPORTED LONG-TERM CREW OF 3, BUT WAS ALSO DOCKED IN SHORT MISSIONS BY AMERICAN SPACE SHUTTLES. VISITED BY MANY INTERNATIONAL ASTRONAUTS AND COSMONAUTS AND ALSO SPACE TOURISTS.

